

KEYPLAN: Edificio 1 Viaggiatori

Individuazione Aree

Legenda									
<div>B</div>	Biglietteria IF1	mq 108	<div>INFO</div>	Desk IF1	N° 002	<div></div>	BSS IF1	N° 018	<div>A</div> Locali per servizi di accoglienza e assistenza nella disponibilità del gestore di stazione Grandi Stazioni Retail, al cui sito istituzionale si rimanda per situazione attuale ed evoluzione prevista - www.gsretail.it
<div>B</div>	Biglietteria IF2	mq 60	<div>INFO</div>	Desk IF2	N° 001	<div></div>	BSS IF2	N° 006	
<div>B</div>	Biglietteria IF3	mq 40	<div>INFO</div>	Desk IF3	N° 001	<div></div>	BSS IF3	N° 001	
<div>B</div>	Biglietteria Disponibile	mq	<div>INFO</div>	Desk Disponibile	N°	<div></div>	BSS Disponibile	N°	
<div></div> Altri Locali Grandi Stazioni Retail S.p.A. - www.gsretail.it									

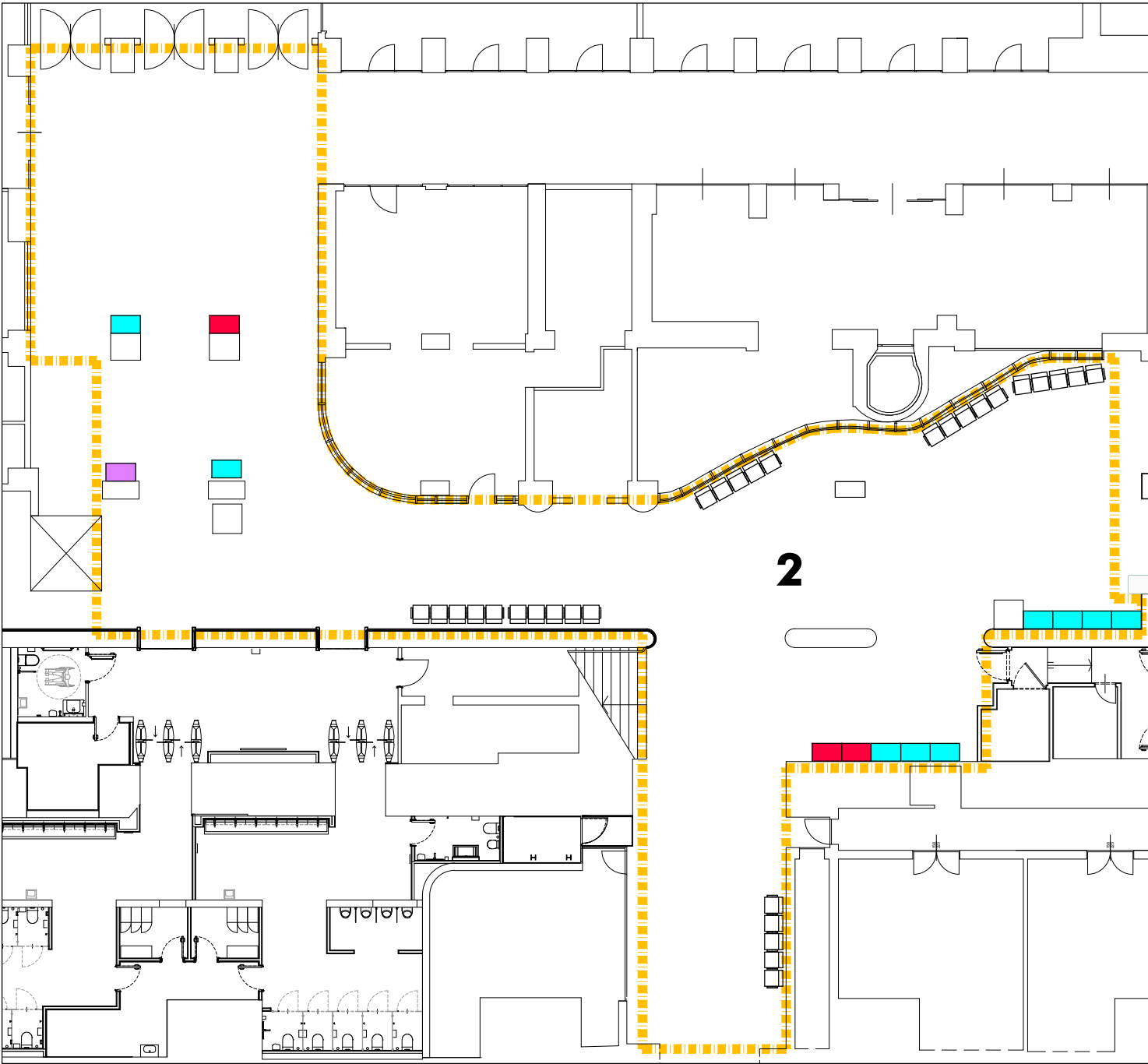

Area 2: Ingresso sottopasso laterale

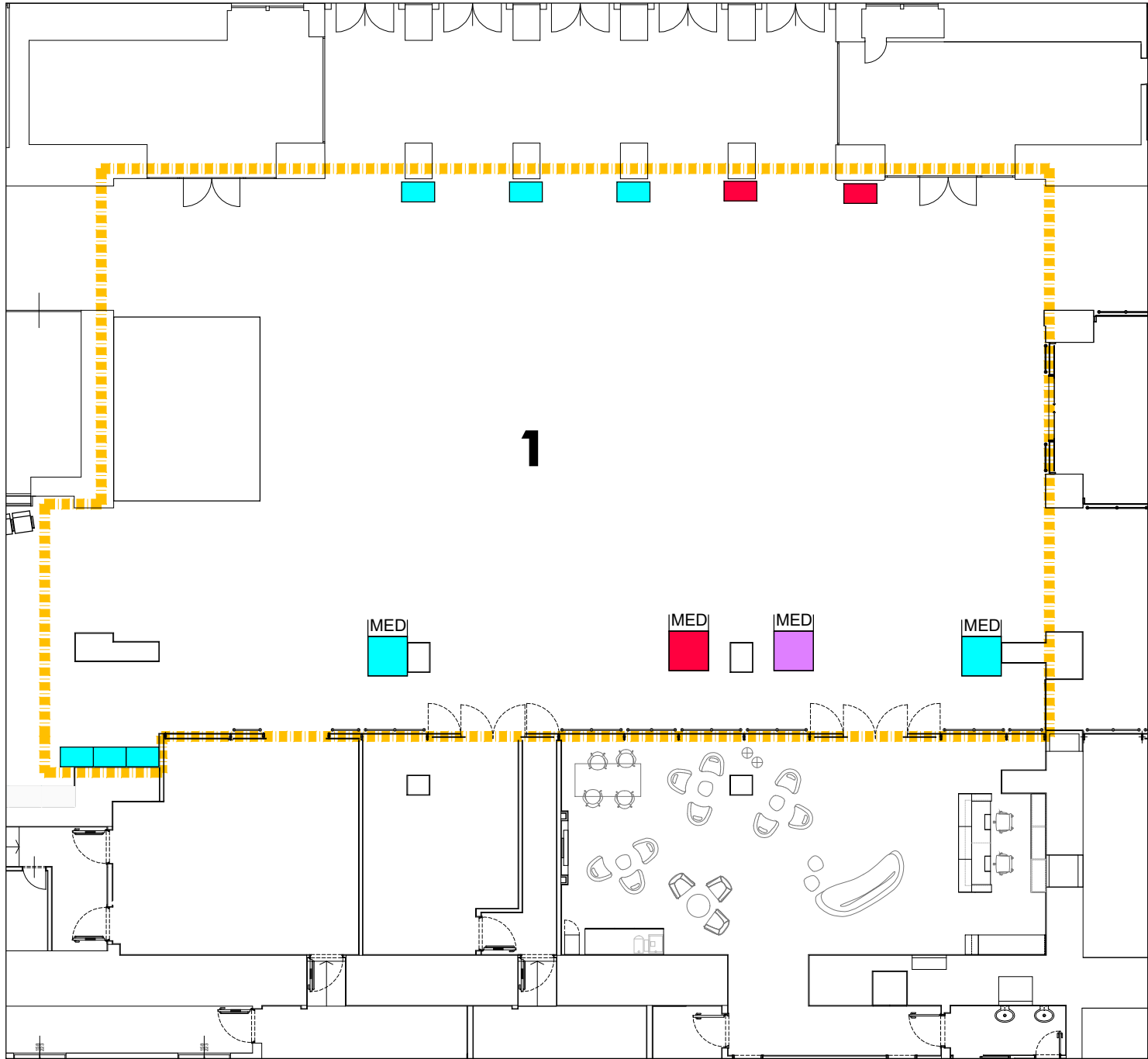

















AREA 1: Ingresso Principale

MAX
Area Desk - Ingombro MAX (200x200x250 – mq max 3,8)

MED
Area Desk – Ingombro MED (140x120x230)

MIN
Area Desk – Ingombro MIN (100x50x230)

Area 2			
 Desk IF1	N°	 BSS IF1	N° 009
 Desk IF2	N°	 BSS IF2	N° 003
 Desk IF3	N°	 BSS IF3	N° 001
 Desk Disponibile	N°	 BSS Disponibile	N°

Area 1			
 Desk IF1	N° 002	 BSS IF1	N° 006
 Desk IF2	N° 001	 BSS IF2	N° 002
 Desk IF3	N° 001	 BSS IF3	N°
 Desk Disponibile	N°	 BSS Disponibile	N°

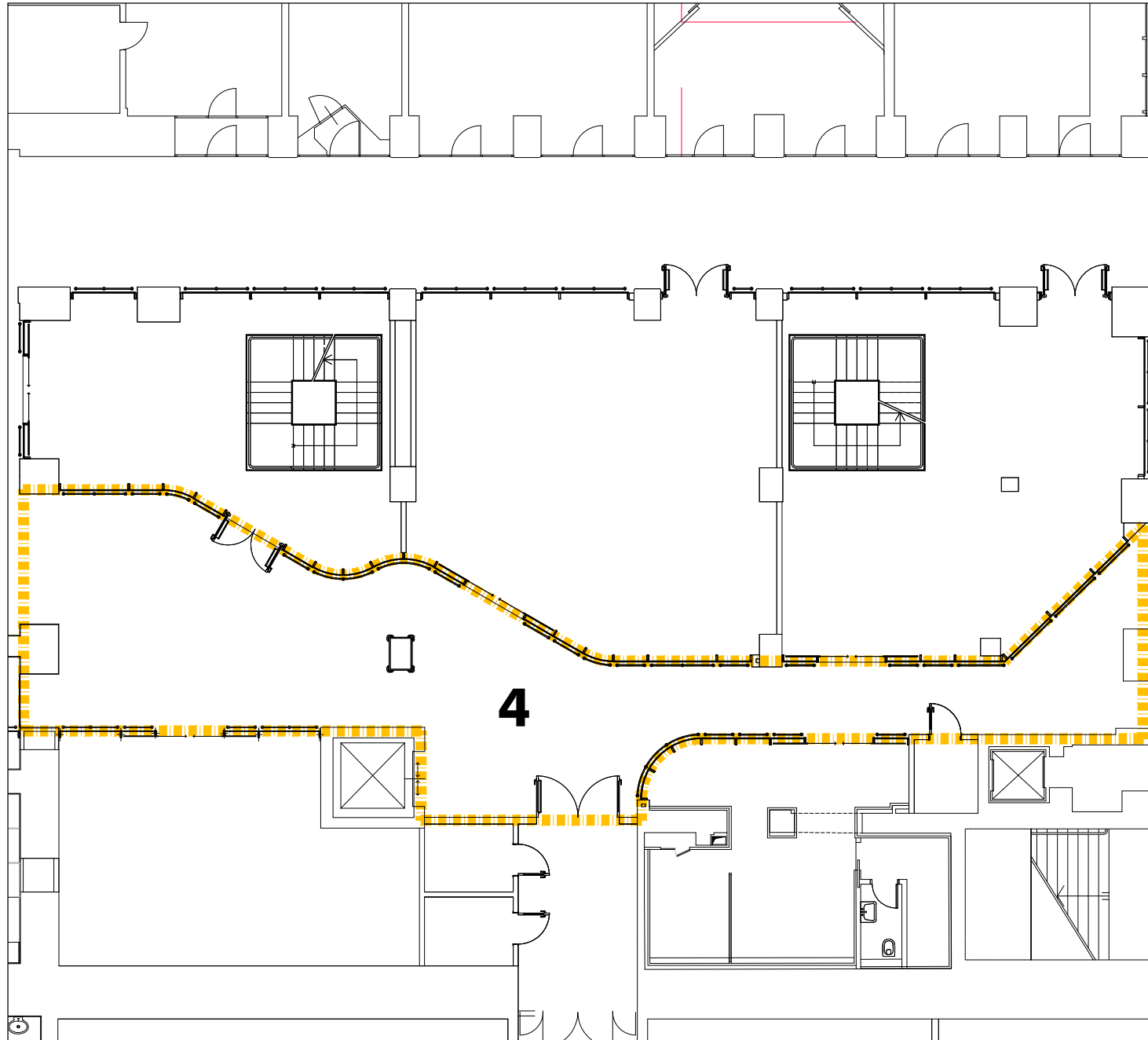

AREA 4: Galleria centrale

Individuazione Area

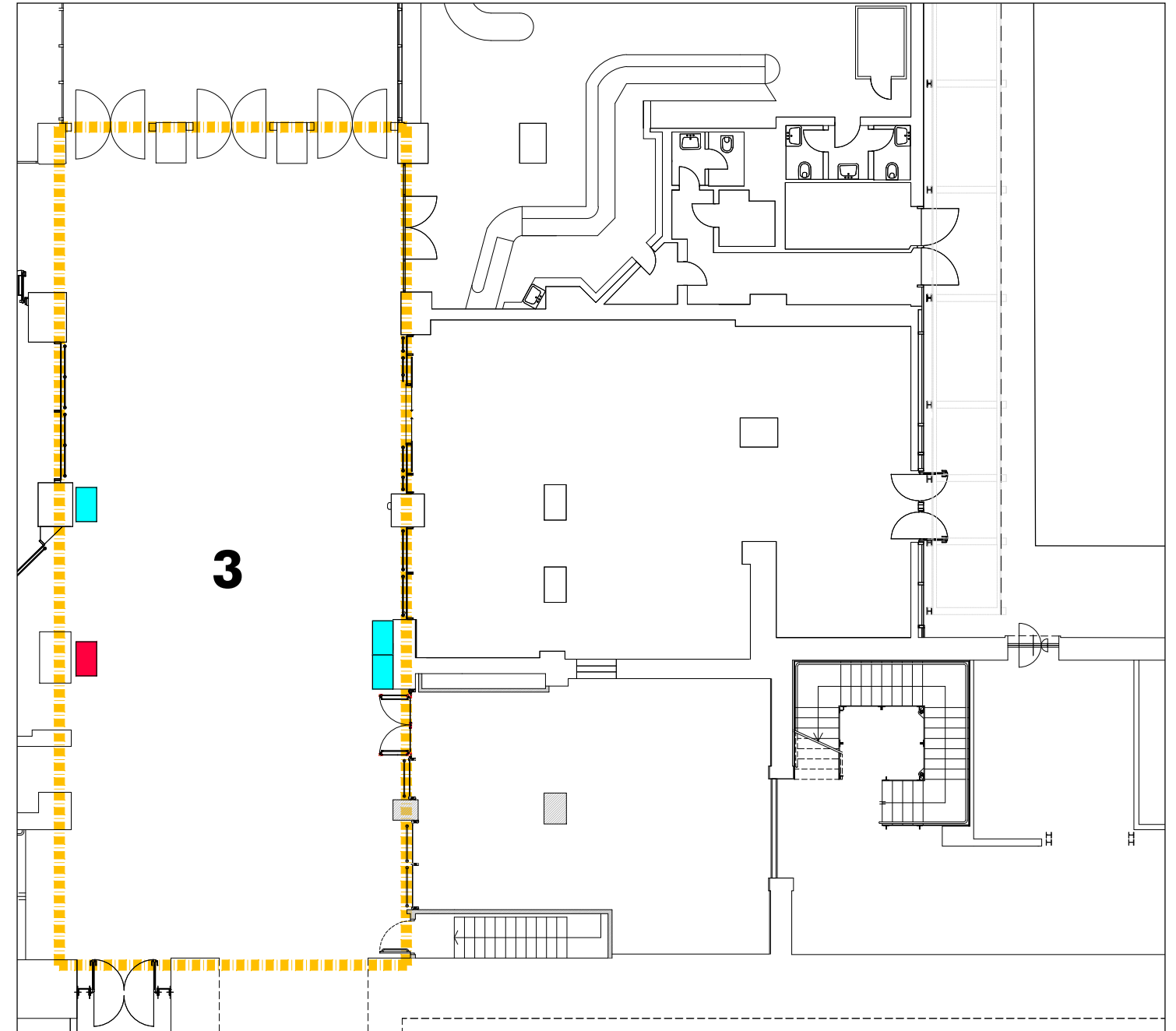

AREA 3: Ingresso antistante sottopasso



Area Desk - Ingombro MAX (200x200x250 – mq max 3,8)











Area Desk – Ingombro MED (140x120x230)











Area Desk – Ingombro MIN (100x50x230)

Area 4

 Desk IF1	N°	 BSS IF1	N°
 Desk IF2	N°	 BSS IF2	N°
 Desk IF3	N°	 BSS IF3	N°
 Desk Disponibile	N°	 BSS Disponibile	N°

Area 3

 Desk IF1	N°	 BSS IF1	N° 003
 Desk IF2	N°	 BSS IF2	N° 001
 Desk IF3	N°	 BSS IF3	N°
 Desk Disponibile	N°	 BSS Disponibile	N°

Biglietterie automatiche e Desk informativi

Area	IIFF	BSS	DESK	Scadenza
1	IF1	6	1	10/12/2033
		-	1	13/12/2025
	IF2	2	1	10/12/2033
	IF3	-	1	12/12/2032
2	IF1	9	-	10/12/2033
		-	-	-
	IF2	3	-	10/12/2033
	IF3	1	-	30/11/2033
3	IF1	3	-	10/12/2033
		-	-	-
	IF2	1	-	10/12/2033
4	IF1	-	-	-
		-	-	-
	IF2	-	-	-
Totale		25	4	

Biglietterie tradizionali

Area	IIFF	MQ lordi	Scadenza
Biglietteria	IF1	108	10/12/2033
	IF2	60	10/12/2033
	IF3	40	12/12/2032
Totale		208	

Numero treni passeggeri*

	N. treni/g in Partenza	N. treni/g in Arrivo	N. treni/g in Transito
Verona Porta Nuova	93	94	121

* Fonte dati Rete Ferroviaria Italiana SpA

Spazi di Accoglienza ad Accesso Libero

Totale Sedute in Stazione: **360**

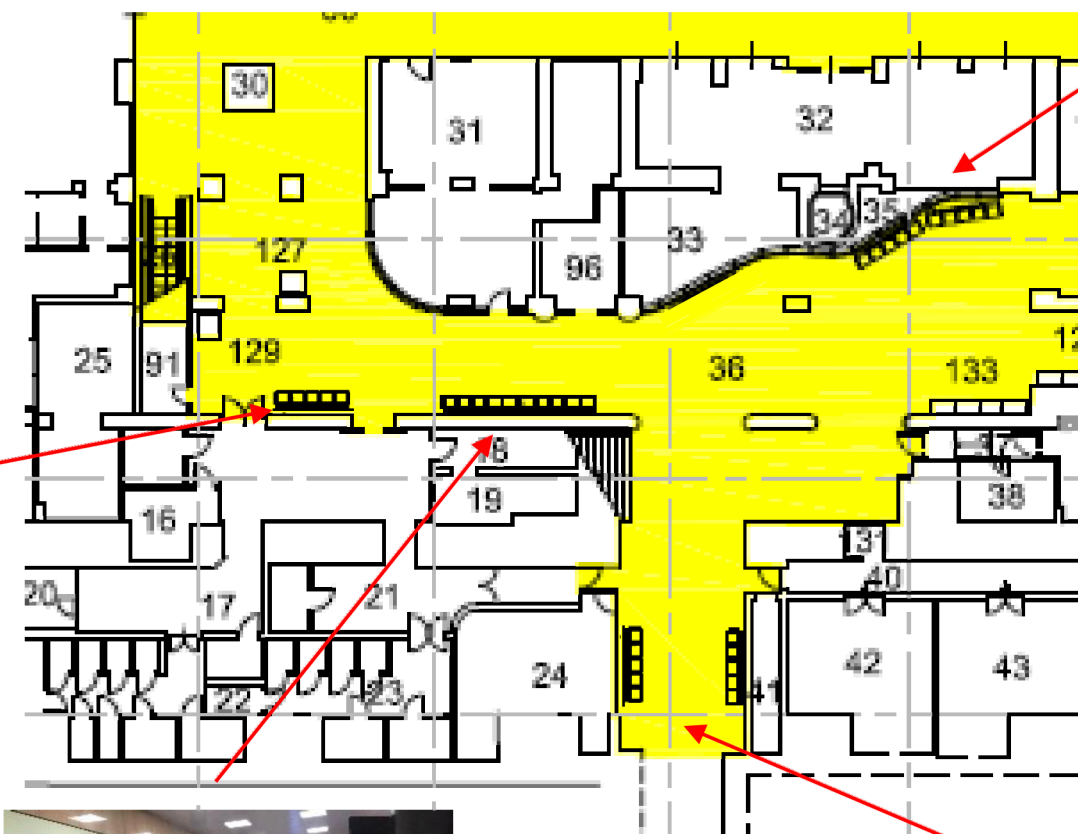

Atrio di Stazione:
35 sedute
(6 panchine)

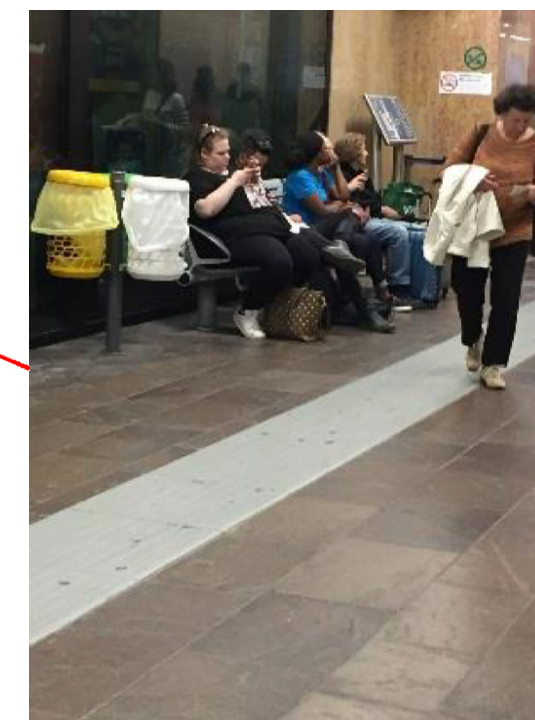

Banchine binari: **325 sedute**

AREA SALE DI ATTESA MARCIAPIEDI : n° 128

AREA 1° MARCIAPIEDE : n°65 (stima per sedute lineari)

AREA 2° MARCIAPIEDE : n°39

AREA 3° MARCIAPIEDE : n°39

AREA 4° MARCIAPIEDE : n°21

AREA 5° MARCIAPIEDE : n°33

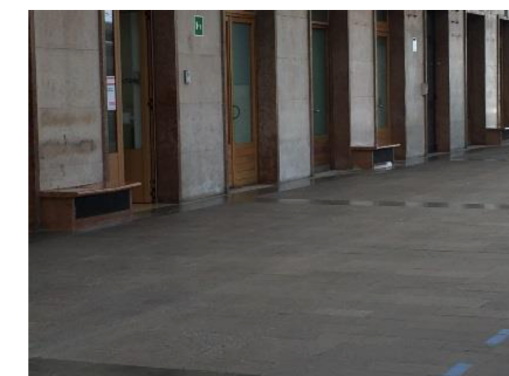
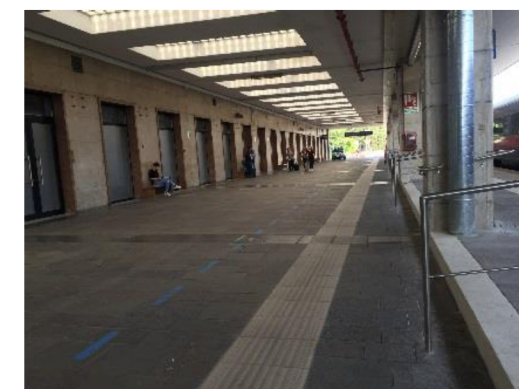

1° MARCIAPIEDI

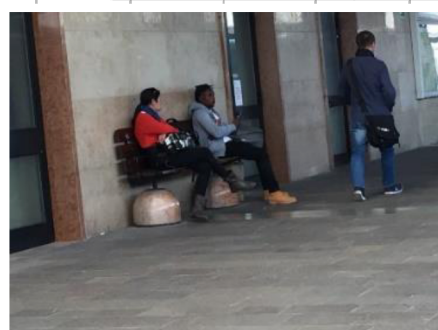
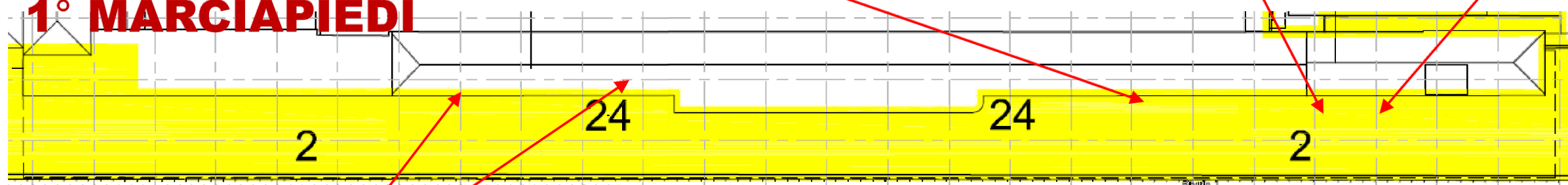

Altri MARCIAPIEDI

