

KEYPLAN: Edificio 1 Viaggiatori

Individuazione Aree

* Spazio oggetto Comunicazione ART (Vedi pagina 8 della Relazione Generale)

Legenda									
B	Biglietteria IF1	mq 258	INFO	Desk IF1	N° 002	BSS IF1	N° 018	A Locali per servizi di accoglienza e assistenza nella disponibilità del gestore di stazione Grandi Stazioni Retail, al cui sito istituzionale si rimanda per situazione attuale ed evoluzione prevista - www.gsretail.it	
B	Biglietteria IF2	mq 16	INFO	Desk IF2	N° 001	BSS IF2	N° 006		
B	Biglietteria IF3	mq 40	INFO	Desk IF3	N° 001	BSS IF3	N° 001		
B	Biglietteria Disponibile	mq	INFO	Desk Disponibile	N°	BSS Disponibile	N°		
								Altri Locali Grandi Stazioni Retail S.p.A. - www.gsretail.it	

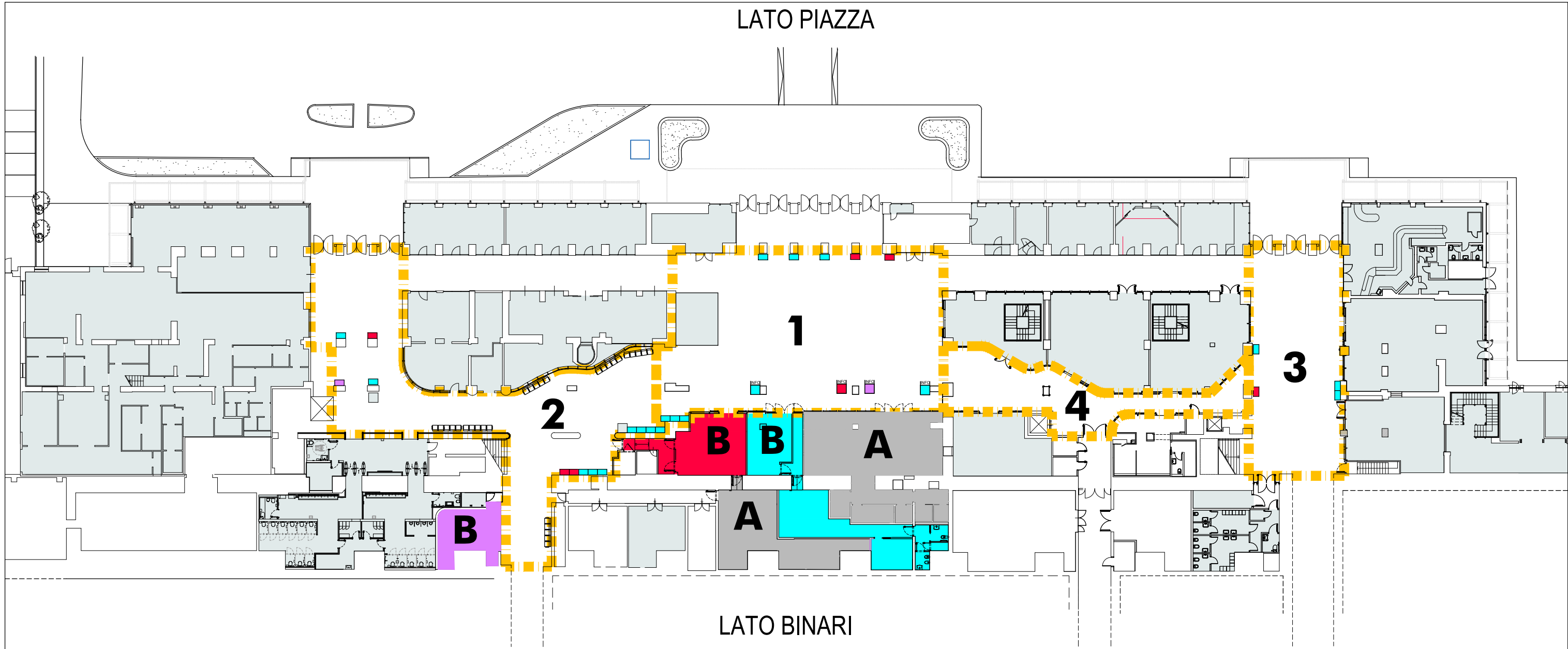

KEYPLAN: Edificio 1 Viaggiatori

Individuazione Aree

Legenda									
<div><div></div><div>B</div></div> Biglietteria IF1	mq 108	<div><div>INFO</div><div></div></div> Desk IF1	N° 002	<div><div></div><div>BSS IF1</div></div>	N° 018	<div><div>A</div><div>Locali per servizi di accoglienza e assistenza nella disponibilità del gestore di stazione Grandi Stazioni Retail, al cui sito istituzionale si rimanda per situazione attuale ed evoluzione prevista - www.gsretail.it</div></div>			
<div><div></div><div>B</div></div> Biglietteria IF2	mq 60	<div><div>INFO</div><div></div></div> Desk IF2	N° 001	<div><div></div><div>BSS IF2</div></div>	N° 006				
<div><div></div><div>B</div></div> Biglietteria IF3	mq 40	<div><div>INFO</div><div></div></div> Desk IF3	N° 001	<div><div></div><div>BSS IF3</div></div>	N° 001				
<div><div></div><div>B</div></div> Biglietteria Disponibile	mq	<div><div>INFO</div><div></div></div> Desk Disponibile	N°	<div><div></div><div>BSS Disponibile</div></div>	N°				
						<div><div></div><div>Altri Locali Grandi Stazioni Retail S.p.A. - www.gsretail.it</div></div>			

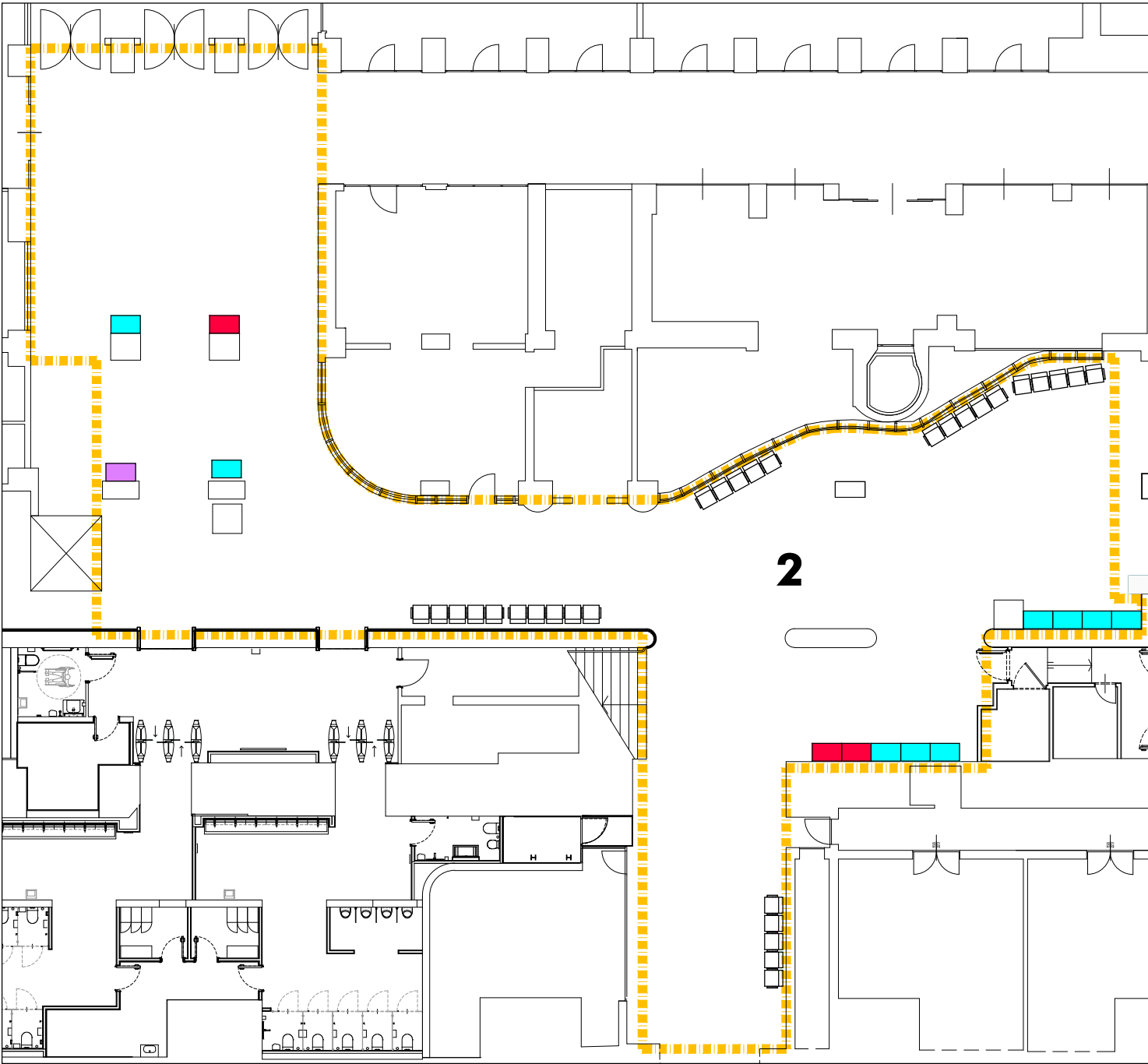

Area 2: Ingresso sottopasso laterale

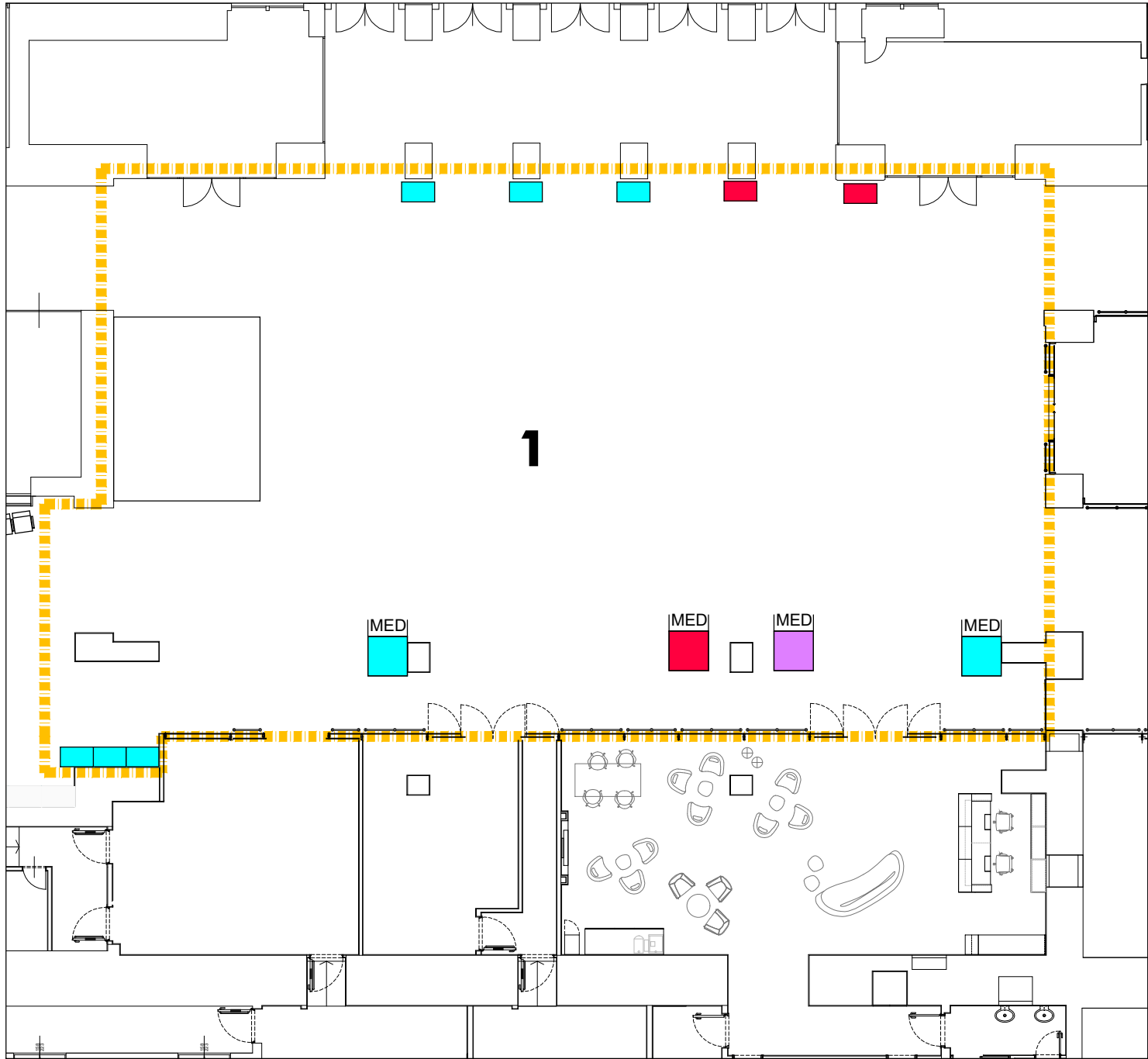









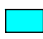





AREA 1: Ingresso Principale

MAX
Area Desk - Ingombro MAX (200x200x250 – mq max 3,8)

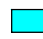
MED
Area Desk – Ingombro MED (140x120x230)

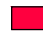
MIN
Area Desk – Ingombro MIN (100x50x230)

Area 2			
 Desk IF1	N°	 BSS IF1	N° 009
 Desk IF2	N°	 BSS IF2	N° 003
 Desk IF3	N°	 BSS IF3	N° 001
 Desk Disponibile	N°	 BSS Disponibile	N°

Area 1			
 Desk IF1	N° 002	 BSS IF1	N° 006
 Desk IF2	N° 001	 BSS IF2	N° 002
 Desk IF3	N° 001	 BSS IF3	N°
 Desk Disponibile	N°	 BSS Disponibile	N°

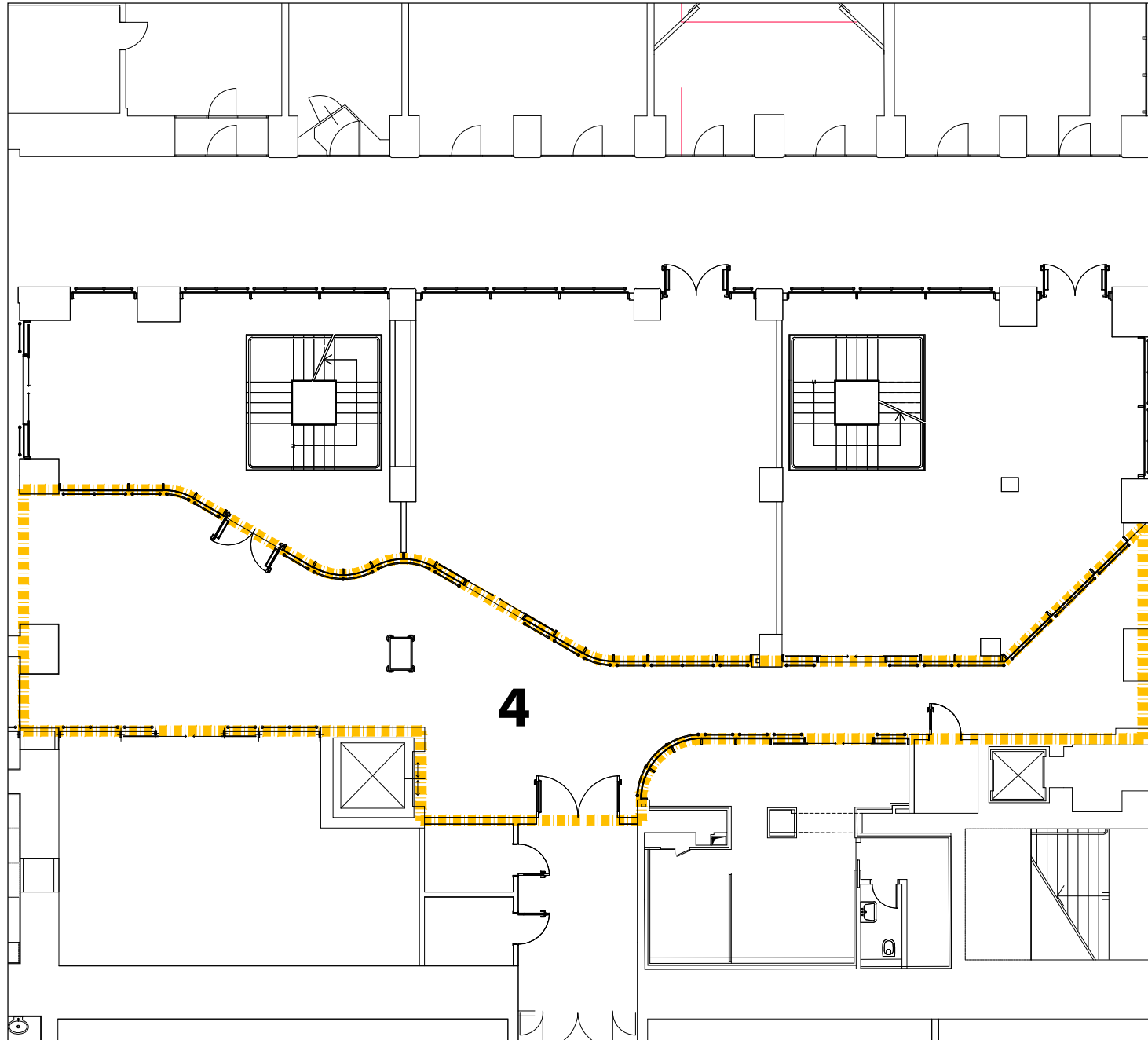

AREA 4: Galleria centrale

Individuazione Area

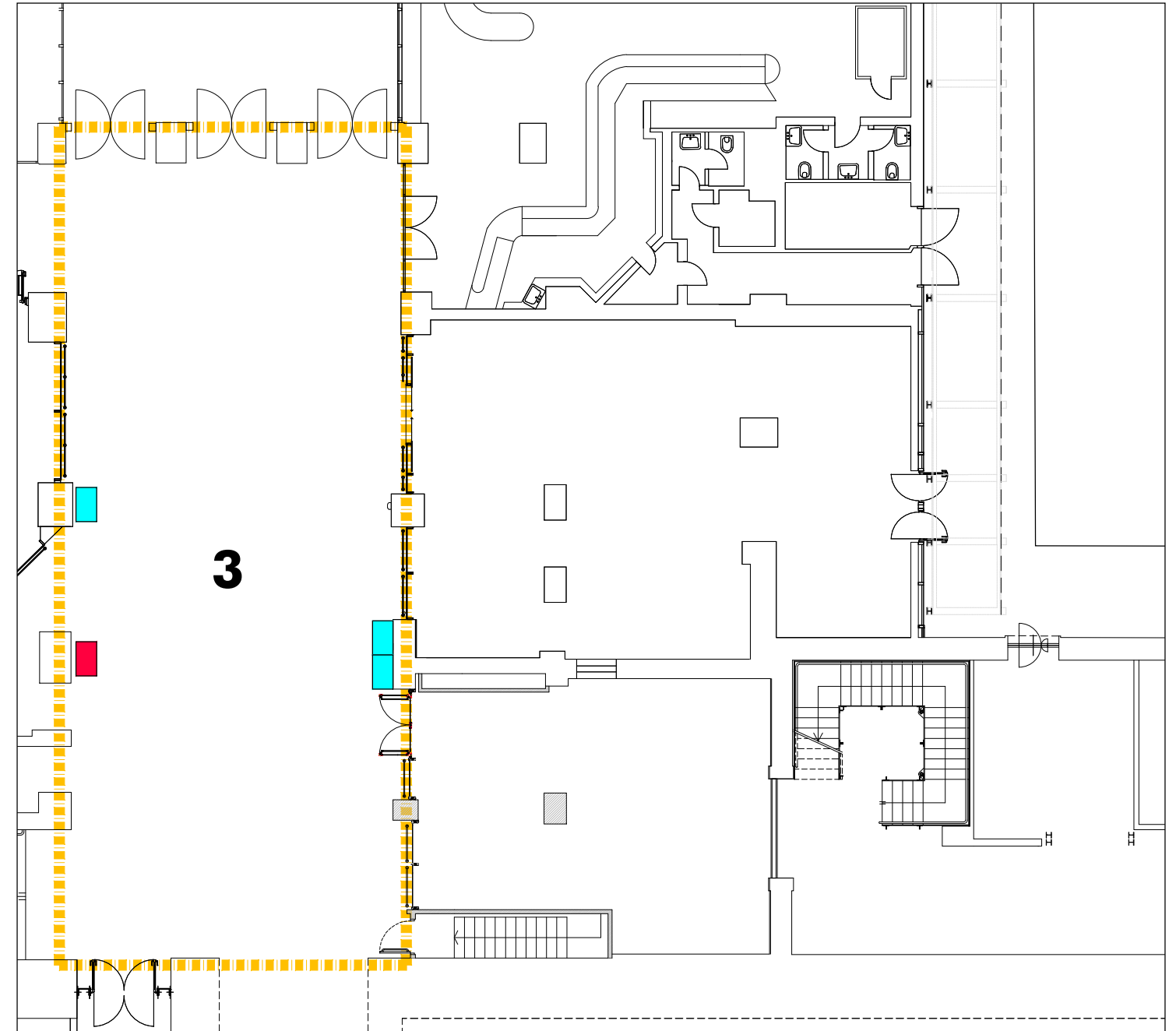

AREA 3: Ingresso antistante sottopasso



Area Desk - Ingombro MAX (200x200x250 – mq max 3,8)









Area Desk – Ingombro MED (140x120x230)

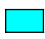





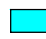

Area Desk – Ingombro MIN (100x50x230)

Area 4

 Desk IF1	N°	 BSS IF1	N°
 Desk IF2	N°	 BSS IF2	N°
 Desk IF3	N°	 BSS IF3	N°
 Desk Disponibile	N°	 BSS Disponibile	N°

Area 3

 Desk IF1	N°	 BSS IF1	N° 003
 Desk IF2	N°	 BSS IF2	N° 001
 Desk IF3	N°	 BSS IF3	N°
 Desk Disponibile	N°	 BSS Disponibile	N°

Biglietterie automatiche e Desk informativi

Area	IIFF	BSS	DESK	Scadenza
1	IF1	6	1	10/12/2033
		-	1	13/12/2025
	IF2	2	1	10/12/2033
	IF3	-	1	12/12/2032
2	IF1	9	-	10/12/2033
		-	-	-
	IF2	3	-	10/12/2033
	IF3	1	-	30/11/2033
3	IF1	3	-	10/12/2033
		-	-	-
	IF2	1	-	10/12/2033
4	IF1	-	-	-
		-	-	-
	IF2	-	-	-
Totale		25	4	

Biglietterie tradizionali

Area	IIFF	MQ lordi	Scadenza
Biglietteria	IF1	258	10/12/2033
	IF2	16	10/12/2033
	IF3	40	12/12/2032
Totale		314	

Numero treni passeggeri*

	N. treni/g in Partenza	N. treni/g in Arrivo	N. treni/g in Transito
Verona Porta Nuova	93	94	121

* Fonte dati Rete Ferroviaria Italiana SpA

Spazi di Accoglienza ad Accesso Libero

Totale Sedute in Stazione: **360**

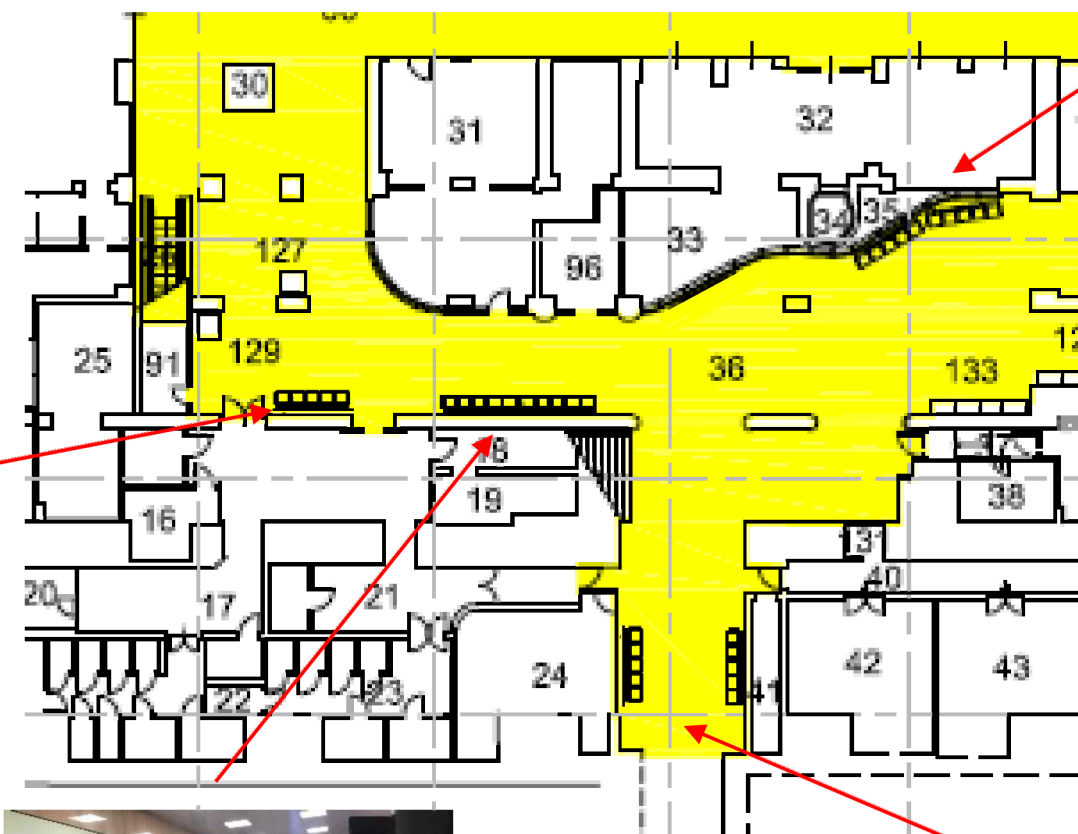

Atrio di Stazione:
35 sedute
(6 panchine)

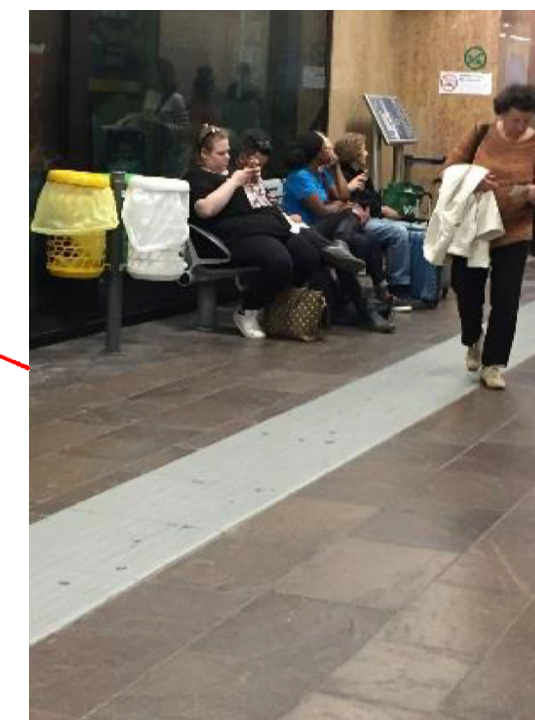

Banchine binari: **325 sedute**

AREA SALE DI ATTESA MARCIAPIEDI : n° 128

AREA 1° MARCIAPIEDE : n°65 (stima per sedute lineari)

AREA 2° MARCIAPIEDE : n°39

AREA 3° MARCIAPIEDE : n°39

AREA 4° MARCIAPIEDE : n°21

AREA 5° MARCIAPIEDE : n°33

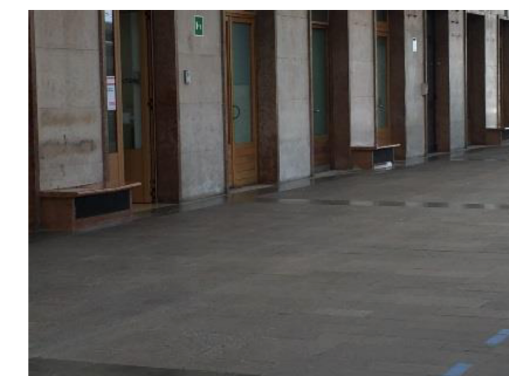
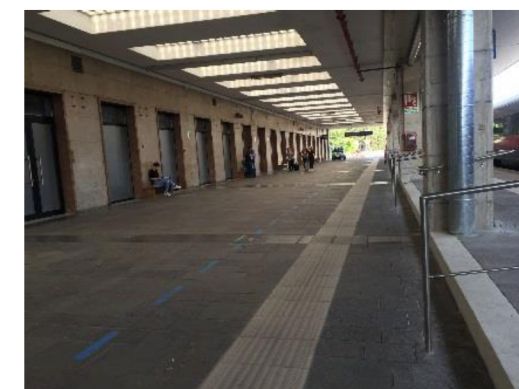

1° MARCIAPIEDI

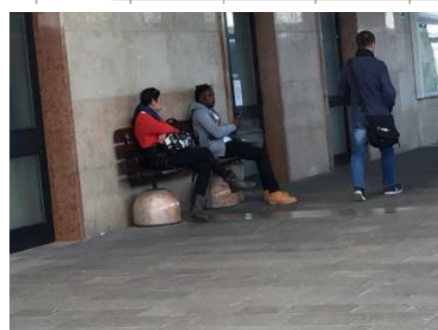
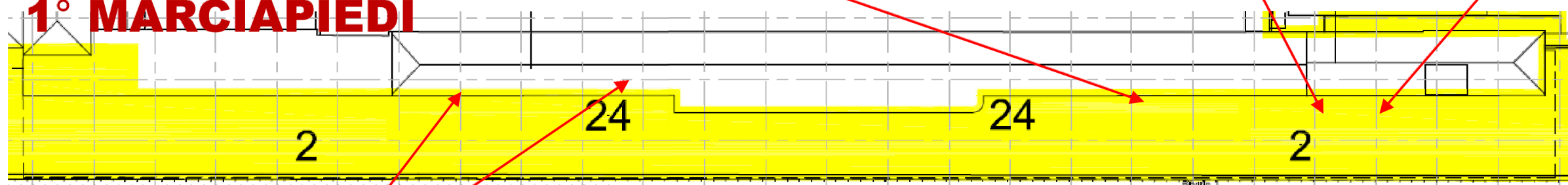

Altri MARCIAPIEDI

